



AVAILABLE BUILDING



**255 Electronics Blvd
Huntsville, AL 35824**

Building Information	
Total square feet	42,000
Available space - minimum sq ft	42,000
Available space - maximum sq ft	42,000
For sale / price	<input type="checkbox"/> Yes <input checked="" type="checkbox"/> No If yes - price = \$
For lease / rate per sq ft	<input checked="" type="checkbox"/> Yes <input type="checkbox"/> No If yes - rate = \$7.40 NNN
Negotiable	<input checked="" type="checkbox"/> Yes <input type="checkbox"/> No
Number of stories	One
Number of buildings	One
Previous use	New construction
Year built	2007
Building construction material	<input type="checkbox"/> Brick <input checked="" type="checkbox"/> Concrete block <input type="checkbox"/> Tilt-up <input type="checkbox"/> Other
Floor thickness	6"
Ceiling height - minimum	24'
Ceiling height - maximum	24'
Dock doors	<input checked="" type="checkbox"/> Yes <input type="checkbox"/> No
Rail access	<input type="checkbox"/> Yes <input checked="" type="checkbox"/> No
Foreign-Trade Zone	<input checked="" type="checkbox"/> Yes <input type="checkbox"/> No FTZ No. 83
Telecommunications	IT network service
Building Location	
Park location & lot size	Jetplex Supplier Park - 4 acres
Distance to major interstate	I-565 -2 mile, 1-65 - 8 miles
Distance to major highway	Hwy 72 West - 7 miles
Distance to major commercial airport	Huntsville International Airport - 1 mile
Distance to port	Decatur - 20 miles
Utilities	
Electric service / provider	<input checked="" type="checkbox"/> Yes <input type="checkbox"/> No Huntsville Utilities
AMP	800
Voltage	480
Phase	3
Natural gas service / provider	<input checked="" type="checkbox"/> Yes <input type="checkbox"/> No Huntsville Utilities
Natural gas line size	4"
Sewer service / provider	<input checked="" type="checkbox"/> Yes <input type="checkbox"/> No City of Huntsville
Sewer line size	8"
Water service	<input checked="" type="checkbox"/> Yes <input type="checkbox"/> No Huntsville Utilities
Water line size	10"

**255 Electronics Blvd
Huntsville, AL 35824
Page 2**

Additional Information

4.93 acre lot -- 7 truck high docks - 40,000 lb levelers -- 2 drive in doors 18' by 20' -- 800 amps of 480 volt 3 phase power -- 60 candle feet at 3 ft aff -- ESFR fire sprinkler -- Located at Intermodal Terminal at the Port of Huntsville

Contact Information

**Laurel Bailey
Graham Bailey Properties
2903 Wall Triana Hwy, Suite 7
Huntsville, Alabama 35824
(256) 461-7482 - Phone
(256) 464-0193 - Fax
(256) 656-9468 - Cell**

www.industrialpropertiesofthesouth.com

or

**Brooks Kracke - Director, Jetplex Industrial Park
Huntsville-Madison County Airport Authority
1000 Glenn Hearn Blvd., Box 20008
Huntsville, Alabama 35824
(256) 772-9395 - Phone
(256) 772-0305 - Fax
brooks@hsvairport.org
www.hsvairport.org**

Updated: 11/01/09



Lot 11
at *Jetplex Industrial Park*
255 Electronics Blvd
Huntsville, AL 35824

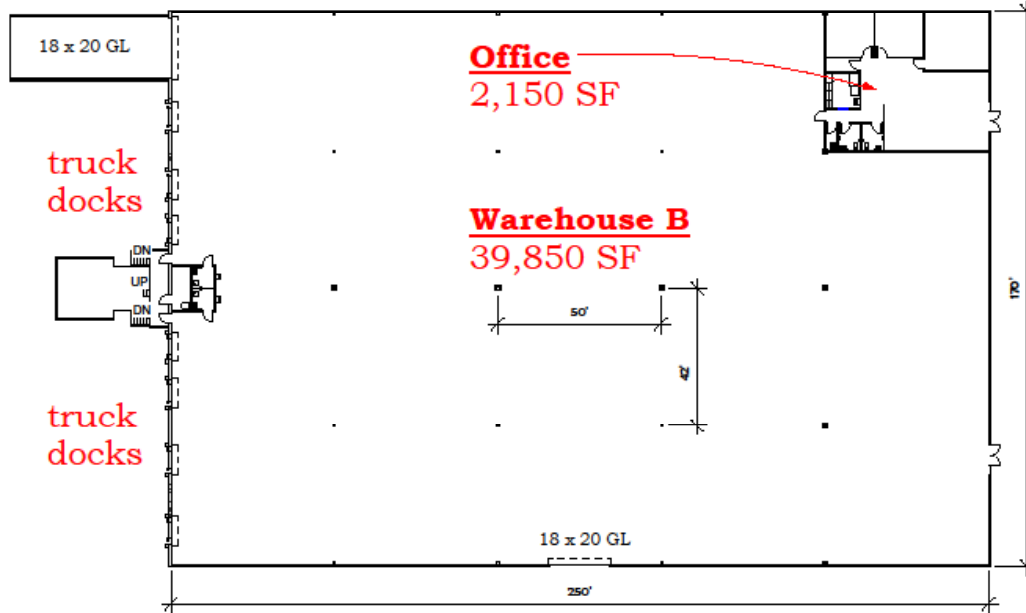

office: 2,150 SF
warehouse B: 39,850 SF
total: 42,000 SF



- 4.93 acre lot
- 7 truck high docks - 40,000 lb levelers
- 2 drive in doors 18' by 20'
- 800 amps of 480 volt 3 phase power
- 60 candle feet at 3 ft aff
- ESFR fire sprinkler
- Located at Intermodal Terminal at te Port of Huntsville

Contact Laurel Bailey
office: 256-461-7482
cell: 256-656-9468
2903 Wall Triana Highway #7
Huntsville, AL 35824

255 Electronics Blvd
Huntsville, AL 35824

at *Jetplex Industrial Park*

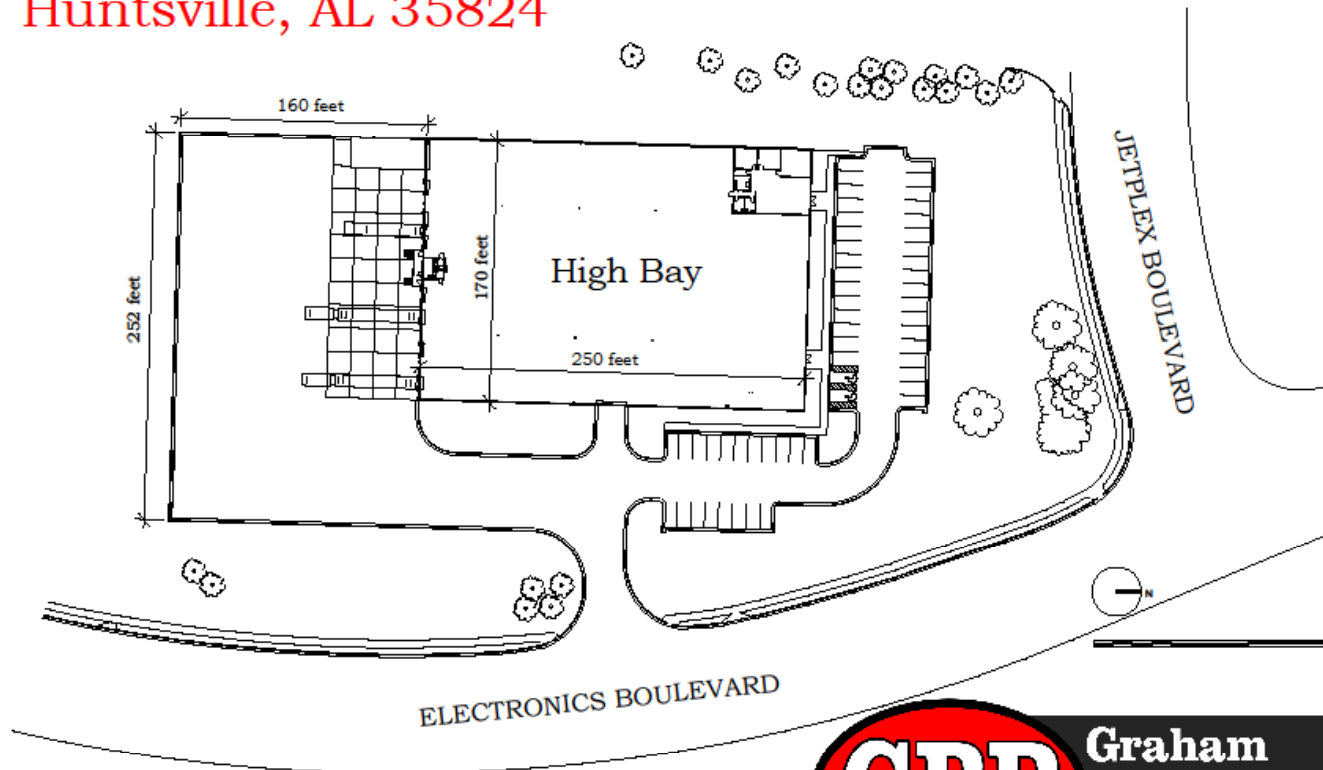

contact **Laurel Bailey**
office: **256-461-7482**
cell: **256-656-9468**



2903 Wall Triana Highway #7
Huntsville, AL 35824



NOT FOR CONSTRUCTION

JETPLEX SUPPLIER PARK
ORTHO PHOTO - JUNE 2008
JETPLEX INDUSTRIAL PARK
MASTER PLAN
 HUNTSVILLE INTERNATIONAL AIRPORT

GWJONES
 & Sons Consulting
 Engineers, Inc.
 Established 1986

HUNTSVILLE INTERNATIONAL AIRPORT
 INTERNATIONAL AIRPORT CENTER
 JETPLEX INDUSTRIAL PARK

DRAWN: HHA SCALE: NOTED SHEET NO. 3 OF 14
 CHECKED: JHY DATE: SEPT. 2008

CIVIL WORK ORDER NO. 04-002

